

MUDR - PD50

SHIPPING INFO

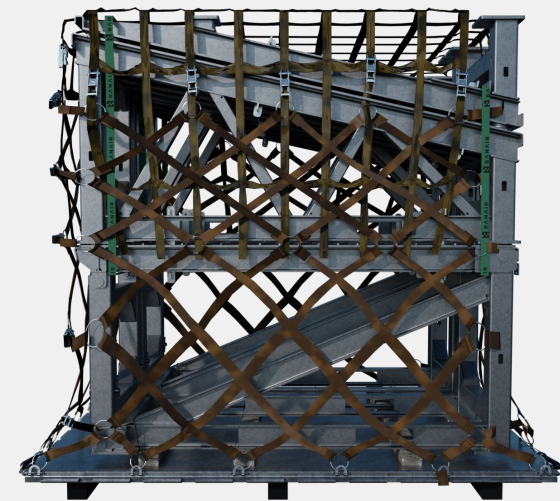
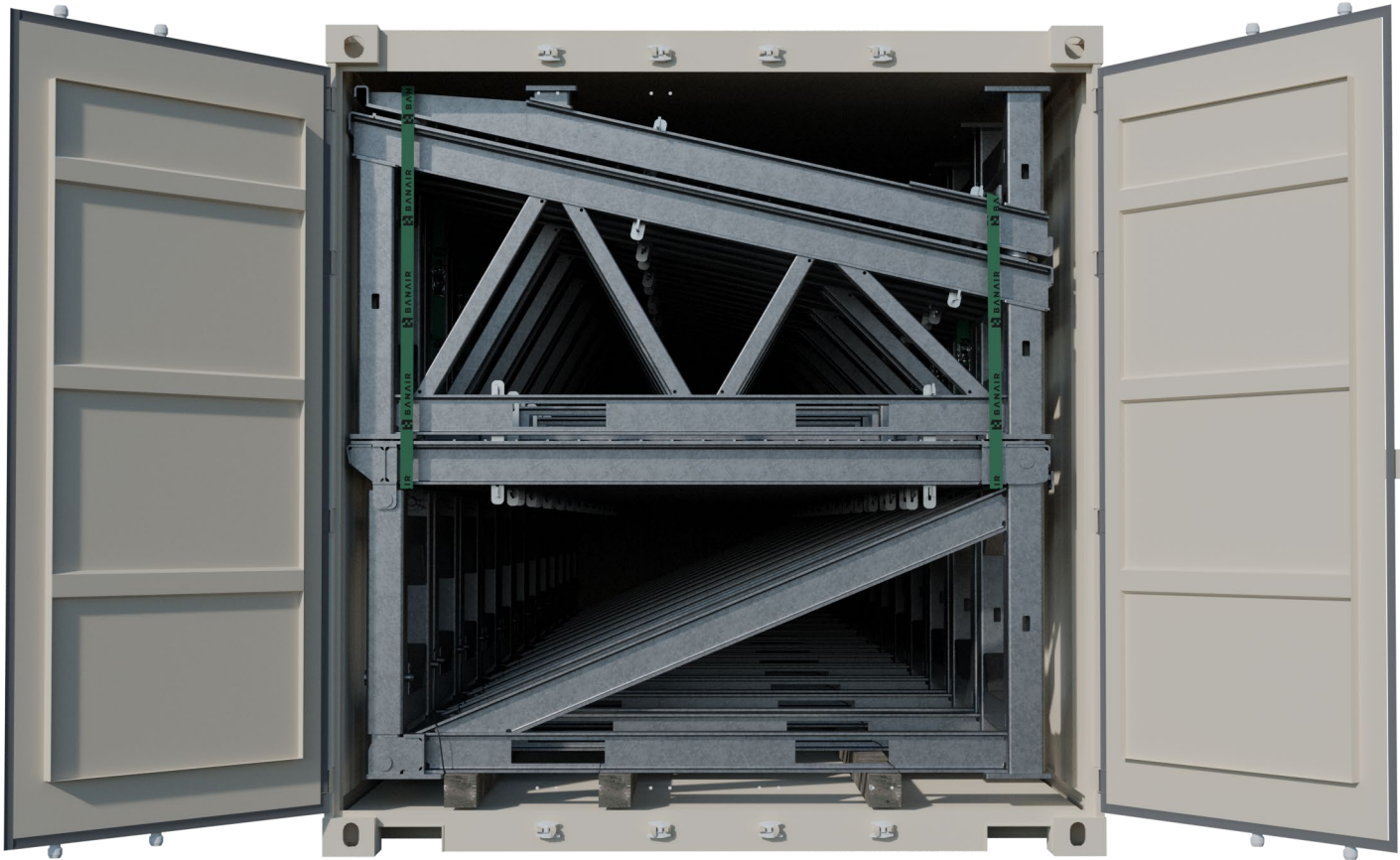

MUDR - PD50

SHIPPING INFO

REFERENCE

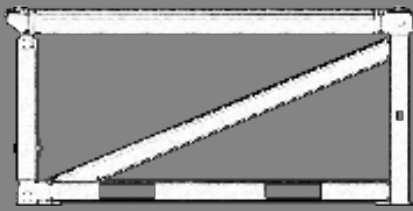

RAMP SECTION 1
(PLATFORM)

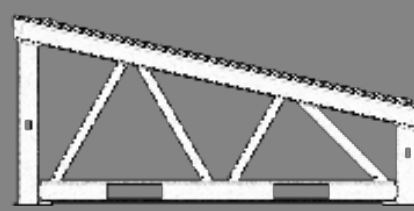

RAMP SECTION 2
(INCLINE)



RAMP SECTION 3
(TOE)



NOSE



Each 40ft Shipping Container holds 12 MUDR-PD50 secured stacks which equates to 6 full MUDR-PD50 systems.

1 MUDR-PD50 stack is shown in the image

MUDR - PD50

SHIPPING INFO

REFERENCE

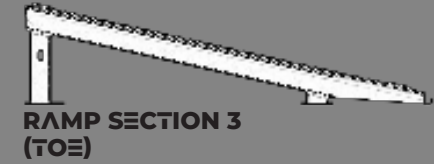
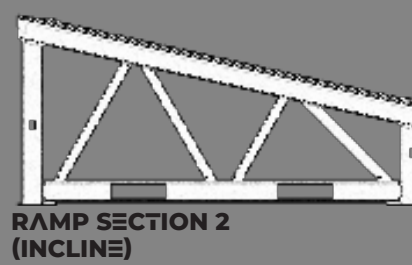
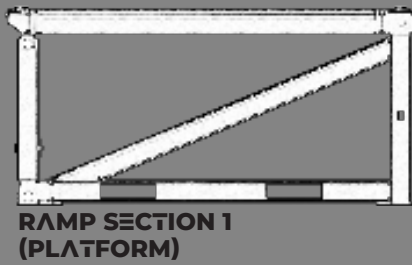

NOSE



RAMP SECTION 3 - TOE

DUAL PURPOSE STRAPPING (SEE GUIDE)
2 SECTIONS

RAMP SECTION 2 - INCLINE

LINKING PLATE AND LOCKING PIN SET
8 POSITIONS

RAMP SECTION 1-PLATFORM

SUPPLIED DUNNAGE SECTIONS
3 PER STACK-SECURED TO RAMP SECTION 1

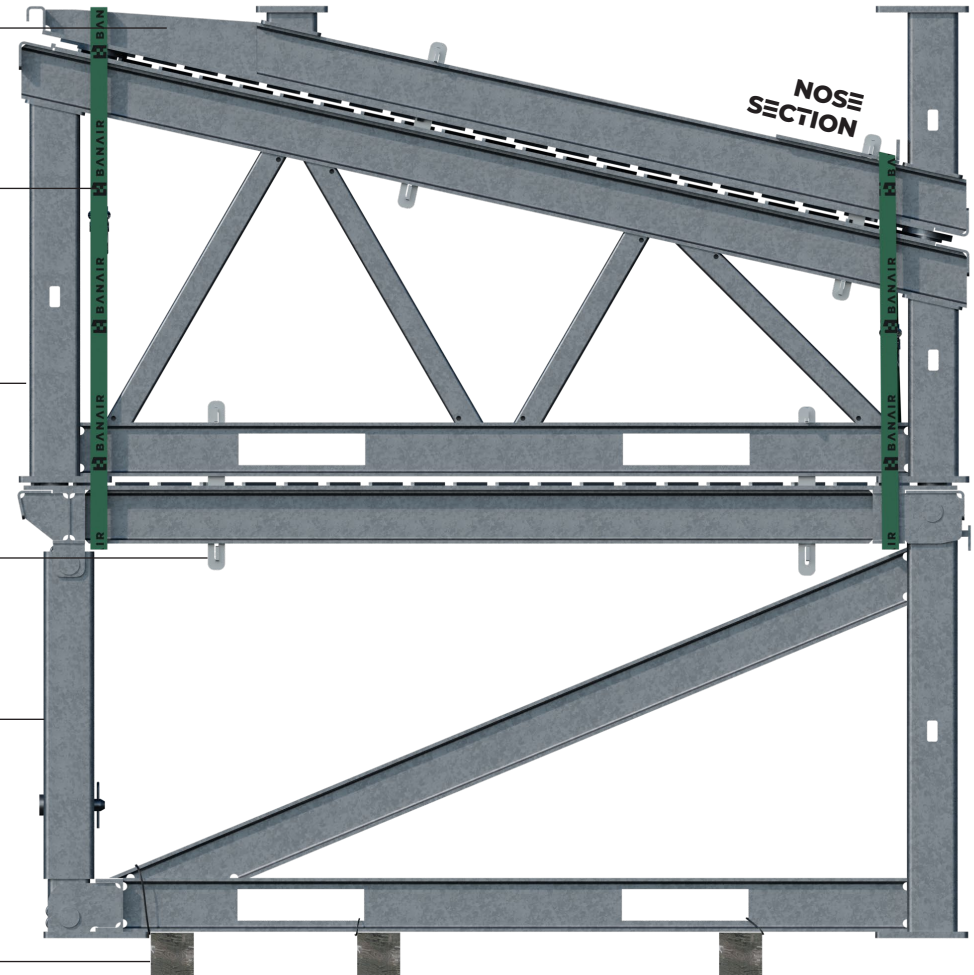

NOSE
SECTION

Each stack is shipped and fully secured in preparation for deployment to the operation site.

IMPORTANT: DO NOT REMOVE OR TAMPER WITH ANY PART OF THE STACK BETWEEN REMOVAL FROM THE SHIPPING CONTAINER AND SITING ON THE 463L PALLET. EACH STACK INCLUDING THE 3 SECTIONS OF SECURED DUNNAGE, STRAPPING AND LOCKING MECHANISMS ARE PART OF THE SYSTEM AND SHOULD REMAIN IN PLACE UNTIL THE 463L PALLET, INCLUDING BOTH STACKS HAVE ARRIVED AT THE OPERATION SITE.

FAILURE TO COMPLY COULD RESULT IN INJURY OR DAMAGE TO THE PRODUCT

ALL COMPONENTS SHOWN AND LABELLED IN THE ILLUSTRATION ARE PART OF THE SYSTEM AND ARE INTEGRAL TO THE ASSEMBLY OF THE FINISHED RAMP.

MUDR - PD50

SHIPPING INFO

REFERENCE

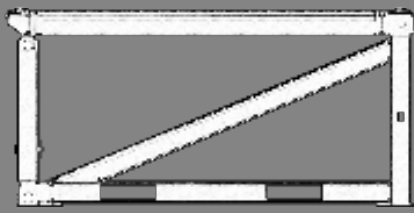

RAMP SECTION 1
(PLATFORM)

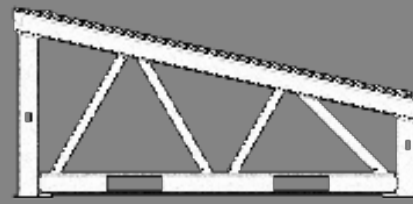

RAMP SECTION 2
(INCLINE)



RAMP SECTION 3
(TOE)

NOSE

Containers have been filled in order of allocation. Remove in correct order and always in multiples of 2 stacks per single 463L pallet. Confirm correct allocation using code found on each stack.



1 1 2 2 3 3 4 4 5 5 6 6

Prepare 463L pallet on dunnage



Site next secured stack from specified container end

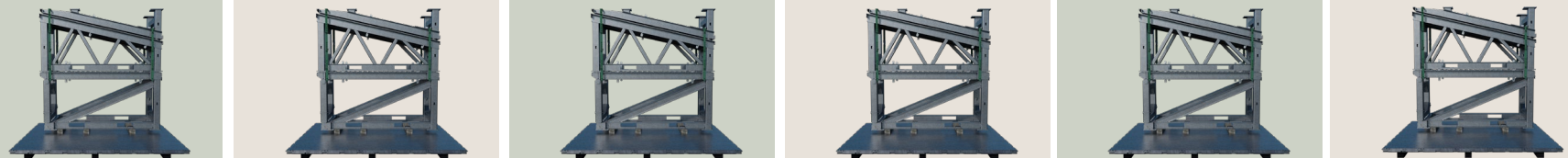

Site next secured stack from specified container end. 2 stacks now in position to complete allocation



Secure cargo netting ready for deployment to site of operations

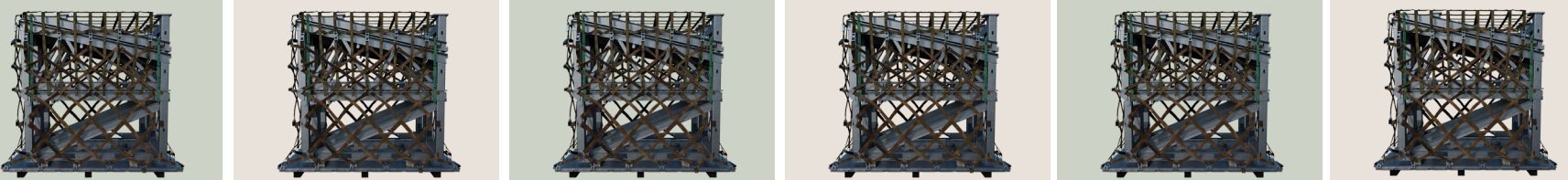

allocation 1 complete

allocation 2 complete

allocation 3 complete

allocation 4 complete

allocation 5 complete

allocation 6 complete

www.BANAIR.com

+1 919 753 8429 (USA)

